

## CAST STEEL GATE VALVES ALV-1

### Nominal Pressure

ANSI Class 150-2500

PN 16-420

### Nominal size

2½"-48"

DN 65-1200

### Materials

Carbon Steel

Low Alloy Steel

Stainless Steel

### Connections

Flanged

Butt Weld

Threaded



**AXELVALVES AB**

Box 11 000, S-161 11 Bromma

Stockholm, Sweden

Phone: +46 (0)8 445 20 60

Fax: +46 (0)8 98 22 35

E-mail: [info@axelvalves.se](mailto:info@axelvalves.se)



**AXELVALVES в России:**

ООО "Флоу Текнолоджи"

190013, Санкт-Петербург

ул.Серпуховская, 10, литер А

Телефон: +7 (812) 313-11-95

[info@flowtechnology.ru](mailto:info@flowtechnology.ru)

AXELVALVES offers a wide range of cast valves to ANSI and DIN standards, designed for the chemical and petrochemical, oil and gas processing, steam generation industries.

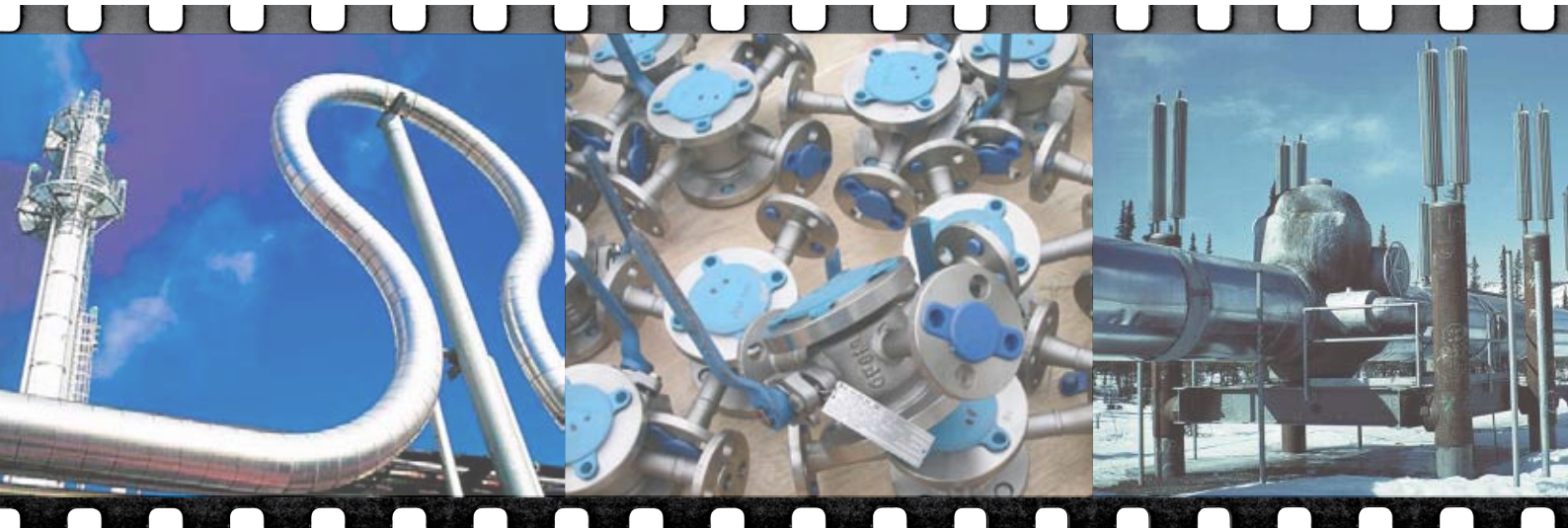

- **Power**
- **Oil & Gas**
- **Petrochemical**
- **Chemical**
- **Marine**
- **Pulp & Paper**
- **Cryogenics**
- **Mining**
- **Construction**

## Features

ALV-1 gate valves are manufactured by using high quality cast materials to guarantee superior performance.

- Valves are fitted with asbestos-free packing.
- Bolted bonnet valves are fitted with a graphite gasket that is fully contained to protect it from over compression and erosion.
- Each valve is checked and supplied with certification according to relevant standards and specifications.

## Marking

Valves are identified by a proper name plate as required by MSS-SP25 with all informations of rating, size, valve body and trim material.

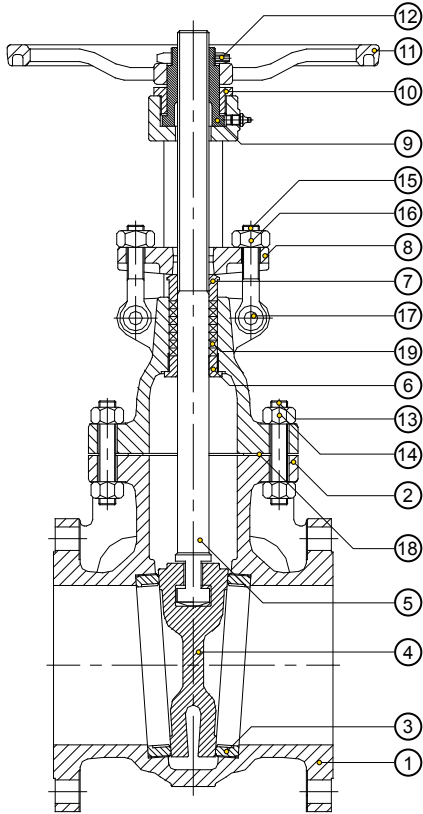

**Standard Material Specification**

No	Part	Material
1	Body	ASTM A 216 WCB
2	Bonnet	ASTM A 216 WCB
3	Seat ring	ASTM A 182 F6
4	Wedge	ASTM A 217 CA15 ≤8"
		ASTM A 216 WCB ≥8"
5	Stem	ASTM A 276 410
6	Stem bushing	ASTM A 276 410
7	Gland	ASTM A 276 410
8	Gland flange	ASTM A 105 II
9	Yoke sleeve	ASTM B 148 9A
10	Yoke nut	ASTM A 105 II
11	Handwheel	Steel
12	Hand wheel nut	ASTM A 105 II
13	Bolts	ASTM A 193 B7
14	Nuts	ASTM A 194 2H
15	Eye bolts	ASTM A 193 B7
16	Nuts	ASTM A 194 2H
17	Eye bolt pin	ASTM A 193 B7
18	Gasket	Graphite
19	Packing	Graphite

**Material Selection Table**

External Material		Trim Material				Sealing Material				
ASTM	Body Bonnet	Bolt	Gland Bolt	Gland Nut	Stem	Seats	Wedge		Packing	Gasket
		ASTM A 193			ASTM A 194	AISI				
							≤8"	≥10"		
A216	WCB	B7	B8	2H	410	F6	CA15	WCB	Graphite	Graphite
A352	LCB	L7	B8	Gr.8	304	304+HF	CF8			
A217	WC6 WC9	B16	B8	2H	410	F11+HF F22+HF	CA15	WC6 WC9		
A351	CF8 CF8M	B8	B8	Gr.8	304 316	CF8 CF8M	CF8 CF8M			

Other materials and material combinations available on request.

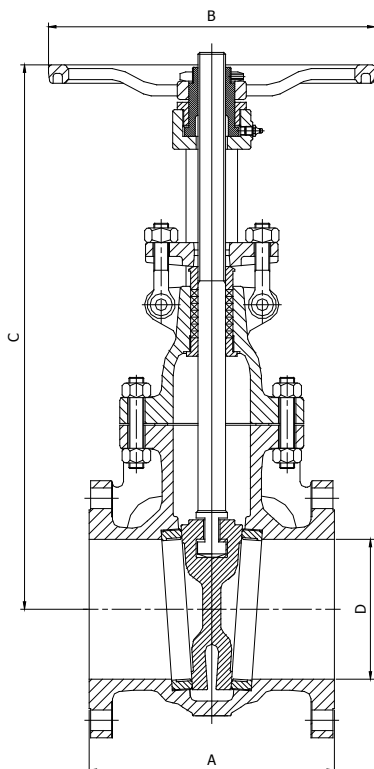

Measurements in mm.

## CLASS 150

Dimensions	Size												
	2 1/2"	3"	4"	5"	6"	8"	10"	12"	14"	16"	18"	20"	24"
A	191	203	229	254	267	292	330	356	381	406	432	457	508
B	200	225	250	250	300	400	500	500	600	600	700	700	800
C (Open)	420	440	480	560	600	775	1050	1240	1300	1500	1650	1800	2200
D	65	80	100	125	150	200	250	300	350	400	450	500	600
Weight kg	28	29	54	56	73	127	222	300	382	495	620	800	1250

## CLASS 300

Dimensions	Size												
	2 1/2"	3"	4"	5"	6"	8"	10"	12"	14"	16"	18"	20"	24"
A	241	283	305	381	403	419	457	502	762	838	915	991	1143
B	200	225	250	300	400	500	500	600	600	700	700	800	900
C (Open)	430	500	530	620	730	910	1110	1240	1400	1580	1700	1900	2150
D	65	80	100	125	150	200	250	300	350	400	450	500	600
Weight kg	33	44	74	113	138	234	338	520	715	995	1350	1680	2050

## CLASS 600

Dimensions	Size												
	2 1/2"	3"	4"	5"	6"	8"	10"	12"	14"	16"	18"	20"	24"
A	330	356	432	508	559	660	787	838	889	991	1092	1194	-
B	65	80	100	125	150	200	250	300	350	400	450	500	-
C (Open)	500	581	673	686	857	1025	1174	1368	1480	1680	1826	1930	-
D	65	80	100	125	150	200	250	300	350	400	450	500	-
Weight kg	44	58	104	178	250	400	840	1000	1400	1960	2744	3842	-



### Test Pressures

Class lbs	Shell/Backseat Hydrostatic bar	Seat Hydrostatic bar	Seat Pneumatic bar
150	31	24	6
300	81	60	6
600	162	119	6

### Valves are Manufactured in Accordance with the Following Standards

API 600	Cast steel valves
API 598	Valve inspection and test
ANSI B 16.34	Steel valve, flanged and butt weld ends
ANSI B 16.5	Steel pipe flanges and flanged fittings
ANSI B16.10	Face to face dimensions of ferrous valves
MSS-SP-25	Standard marking system for valves
MSS-SP-6	Standard finishes for contact faces of pipe, flanges and connecting end flanges of valves and fittings
NACE Mr 01.75	Material requirements: Sulfide stress cracking resistant
BS 5352	Cast and forged steel wedge gate, globe and check valves, screwed and socket weld ends

#### Available on request:

- DIN and GOST Flanges
- Flexible Wedge
- Gear Operated
- Electric Actuated
- Cryogenic Extended Bonnet and Packing
- Heating Jacket
- By Pass
- Other Valve Sizes and Materials Available (Hastelloy C, Titanium, Monel etc.)

#### Design and dimensions:

- According to Standards: ANSI, API, BS, DIN, GOST